

PUTUKAKAITSE RULOO

YGL-1

PAIGALDAMISE JUHEND

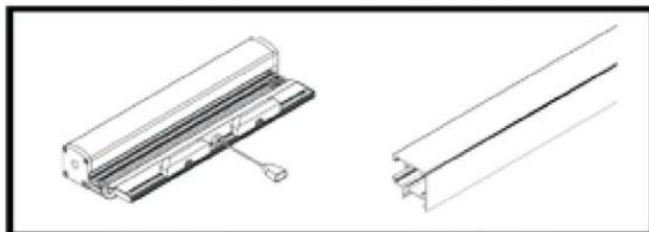

RULOO

RAAM

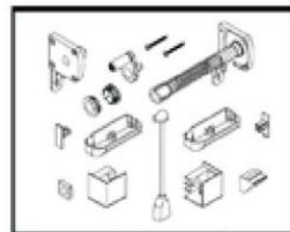

DETAILID

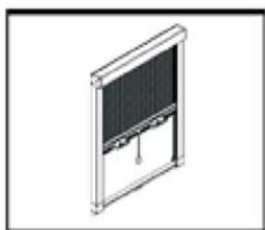

1) Mõõda akna kõrgus ja laius

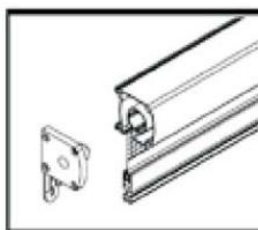

2) Rulookatte vasakust otsast eemalda detailid

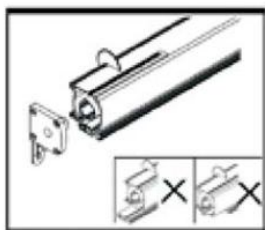

3) Lõika ära liigne rulookattest ja pane otsadetailid külge tagasi

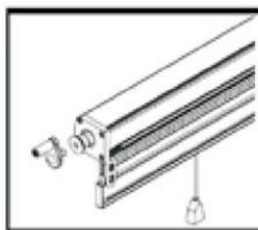

4) Seadista paremast otsast ruloo liikumise tugevus

RULOO PAIGALDAMINE

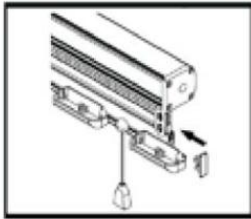

5) Kinnita vajalikud detailid ruloole



6) Kinnita ruloo kruvidega aknale

RAAMI PAIGALDAMINE

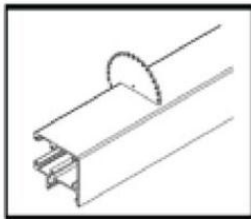

7) Lõika ära liigne osa raamist

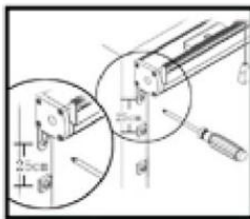

8) Paigalda aknaraamile ruloo kinnitusklambrid
Klambrate vahe max.25 cm

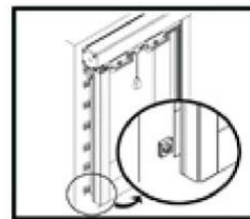

9) Pane paika raam ja kinnita vasakult nurganupuga.
Külgraam peab olema tihedalt vastu rulood

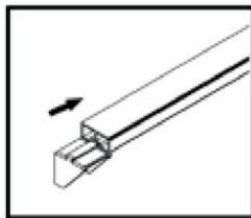

10) Kinnita alumise raami külge klamber

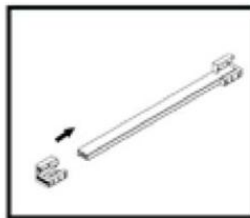

11) Kinnita parem nurganupp

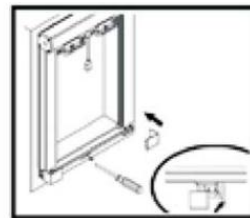

12) Kinnita nurganupp ja klamber kruvidega ja kata kruvid kattenupuga